

FIGURE 4.0a 2007 ADT VOLUMES  
ON RANDALL ROAD AND SIDE ROADS

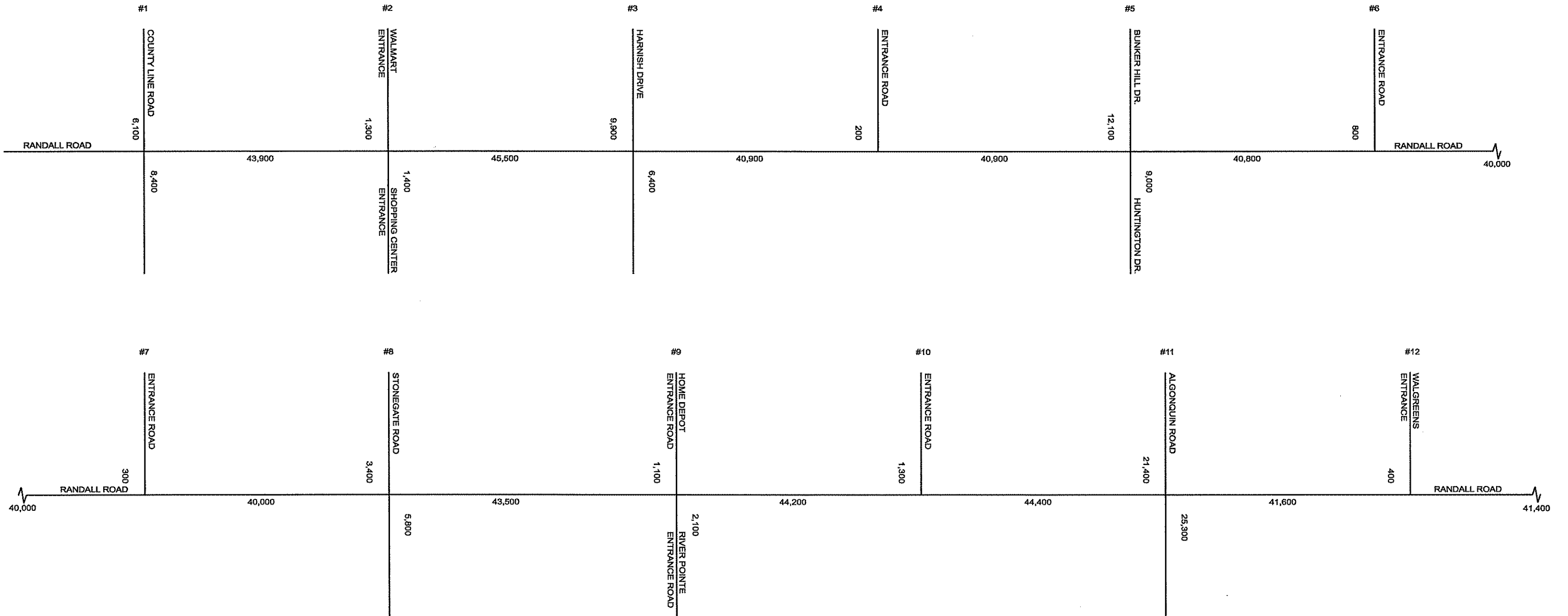
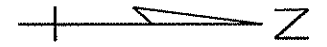

FIGURE 4.0b 2007 ADT VOLUMES  
ON RANDALL ROAD AND SIDE ROADS

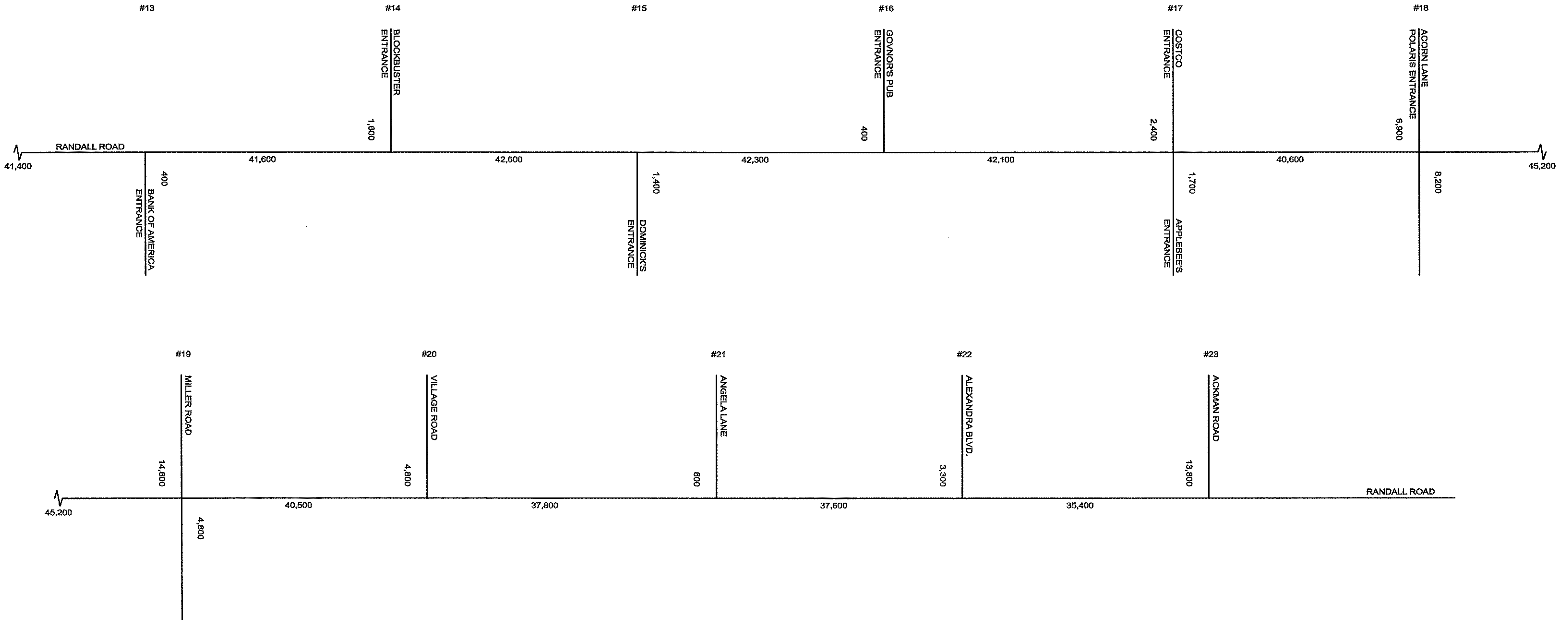
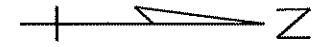

FIGURE 5.0a 2030 ADT VOLUMES  
ON RANDALL ROAD AND SIDE ROADS

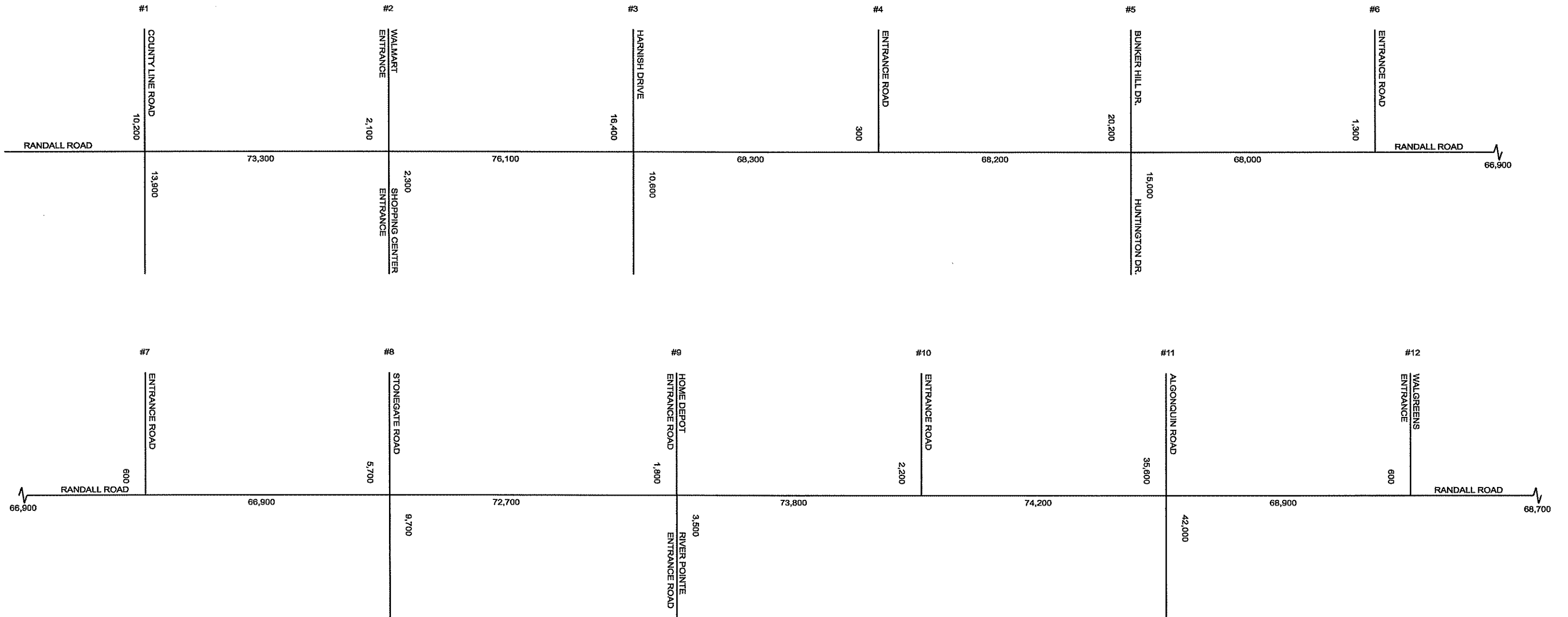
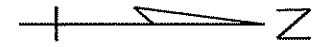

FIGURE 5.0b 2030 ADT VOLUMES  
ON RANDALL ROAD AND SIDE ROADS

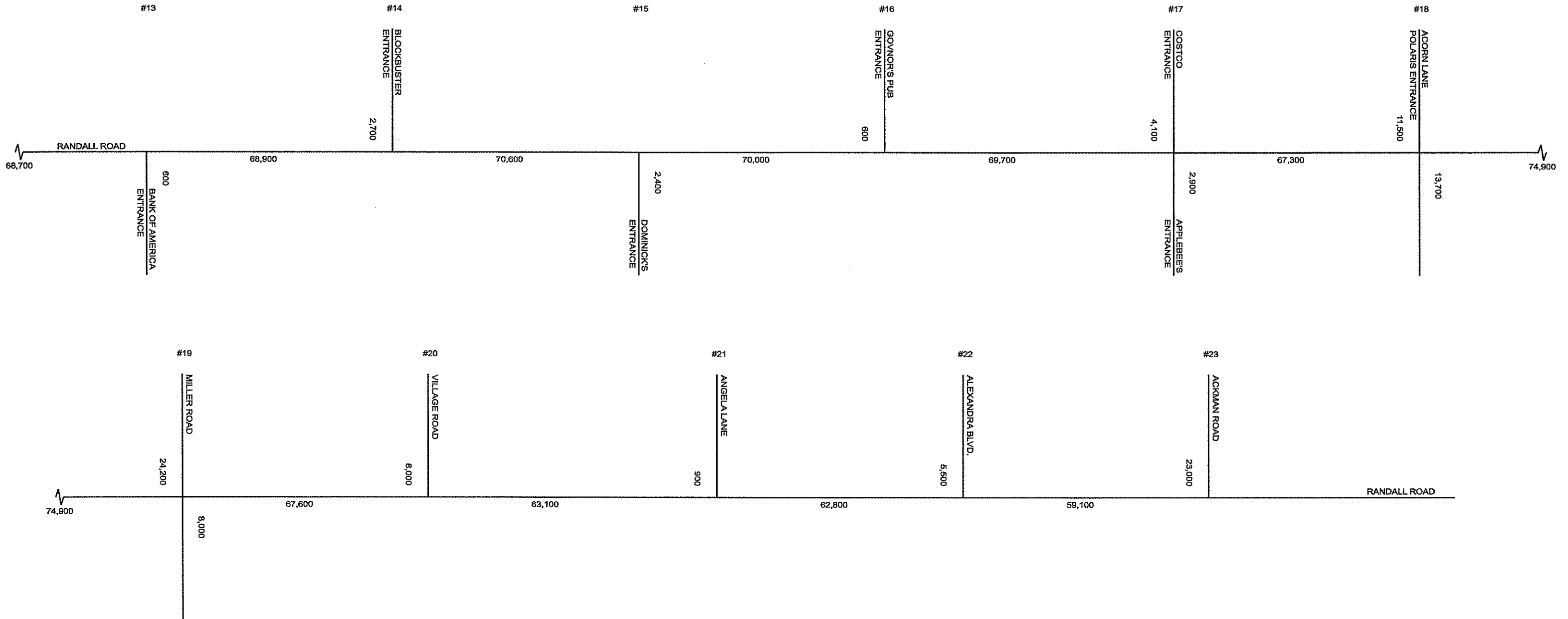
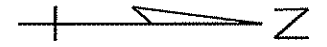
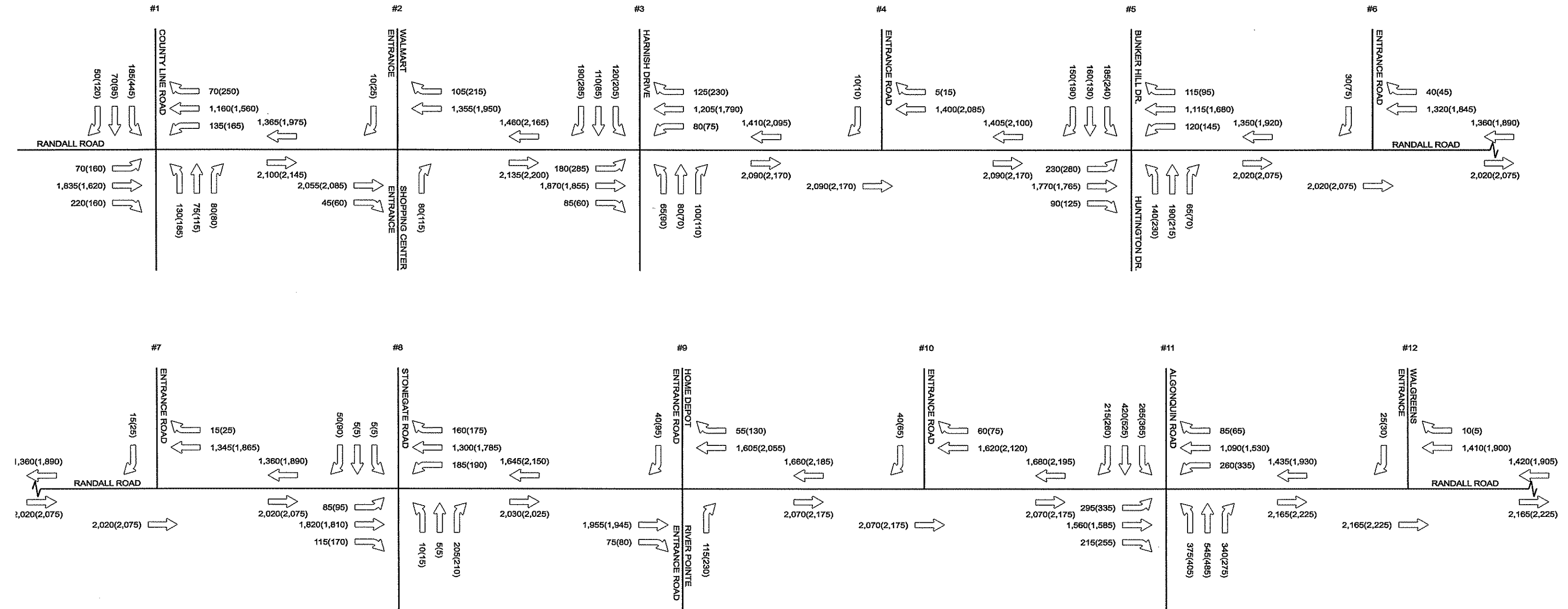
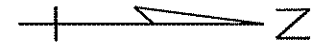
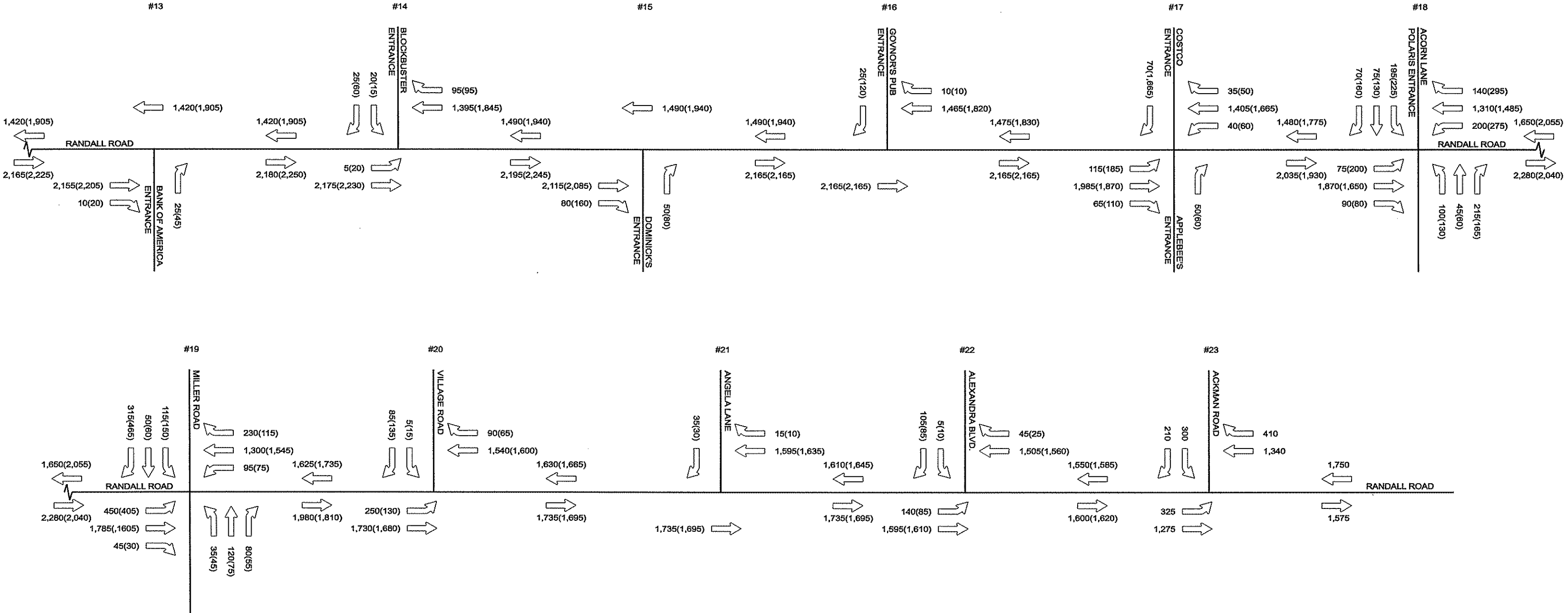
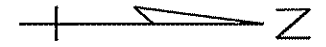

FIGURE 4.1a 2007 PEAK HOUR VOLUMES AND TURNING MOVEMENTS ON RANDALL ROAD AND SIDE ROADS



LEGEND  
0,000(0,000) = WEEKDAY PEAK HOUR VOLUME (WEEKEND PEAK HOUR VOLUME)

FIGURE 4.1b 2007 PEAK HOUR VOLUMES AND TURNING MOVEMENTS ON RANDALL ROAD AND SIDE ROADS



LEGEND  
 0,000(0,000) = WEEKDAY PEAK HOUR VOLUME (WEEKEND PEAK HOUR VOLUME)

FIGURE 6.0a 2030 PEAK HOUR VOLUMES AND TURNING MOVEMENTS ON RANDALL ROAD AND SIDE ROADS

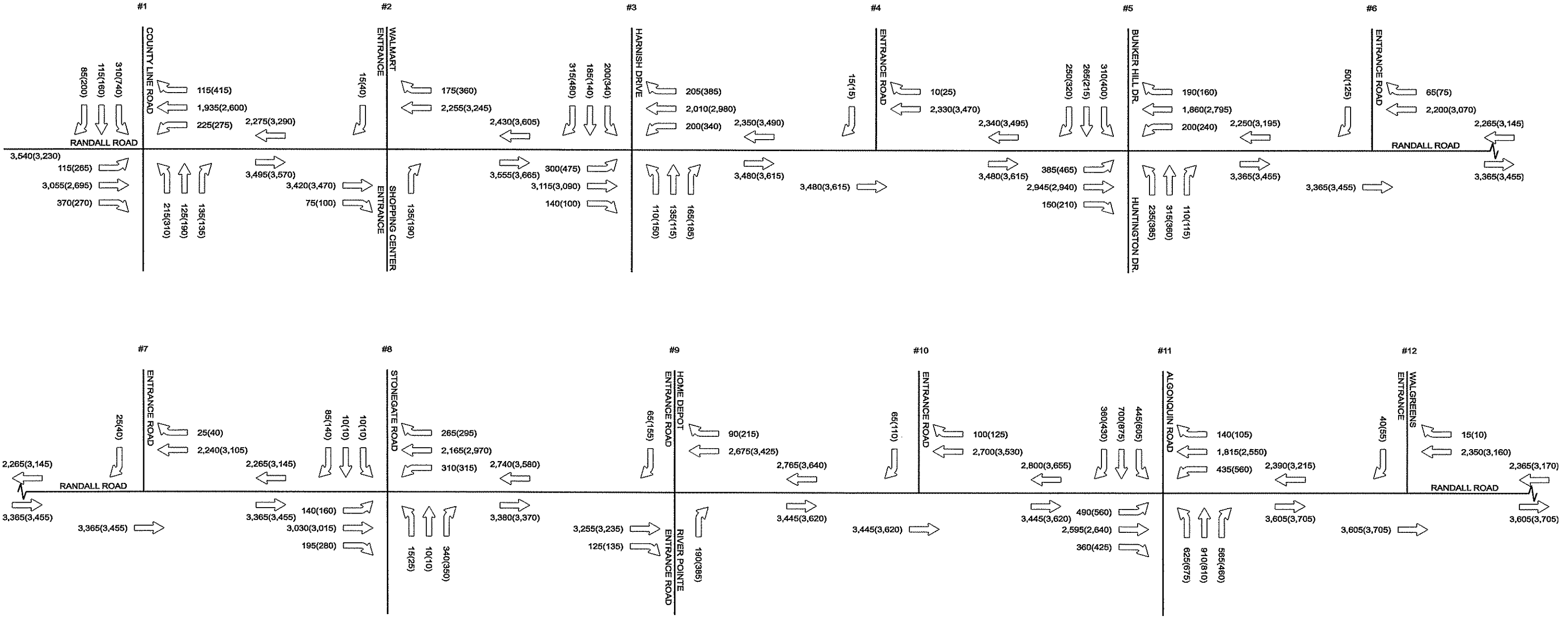
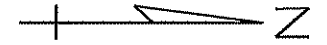

LEGEND  
 0,000(0,000) = WEEKDAY PEAK HOUR VOLUME (WEEKEND PEAK HOUR VOLUME)

FIGURE 6.0b 2030 PEAK HOUR VOLUMES AND TURNING MOVEMENTS ON RANDALL ROAD AND SIDE ROADS

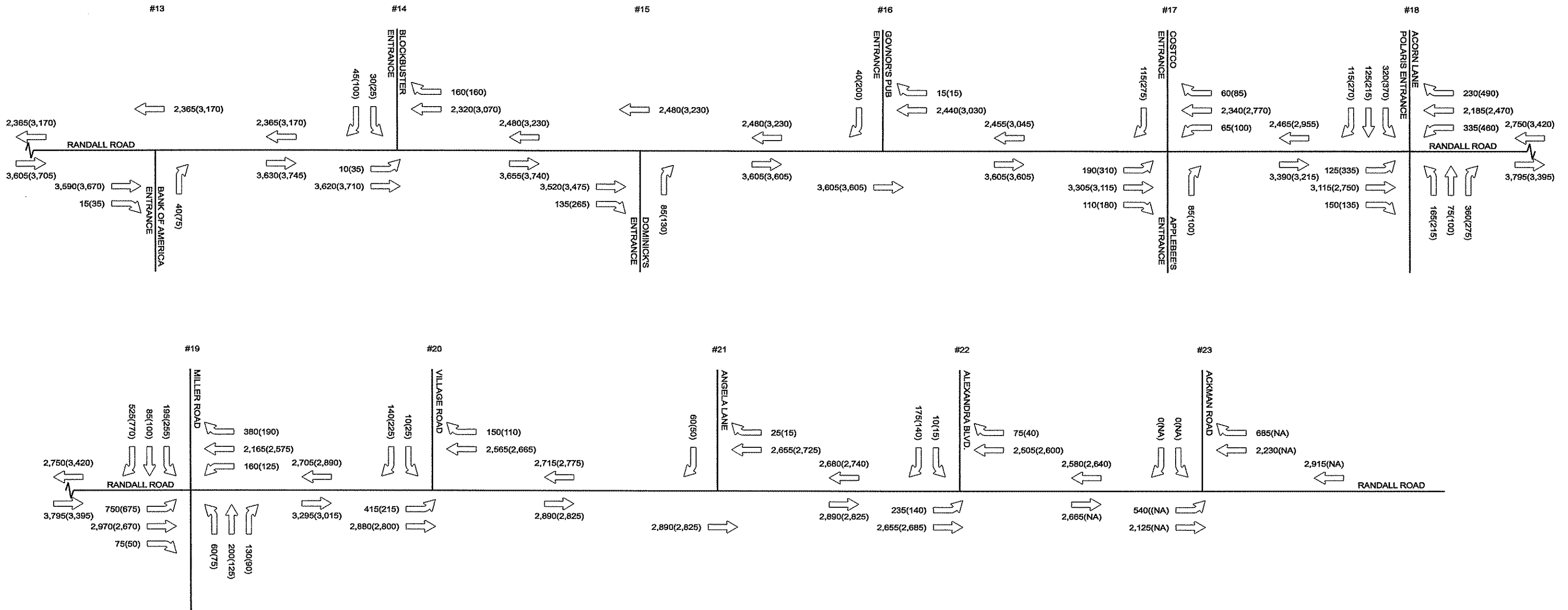
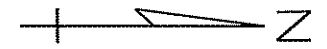

LEGEND  
0,000(0,000) = WEEKDAY PEAK HOUR VOLUME (WEEKEND PEAK HOUR VOLUME)